

GIFFARD

Ceilings - Zindra Clouds

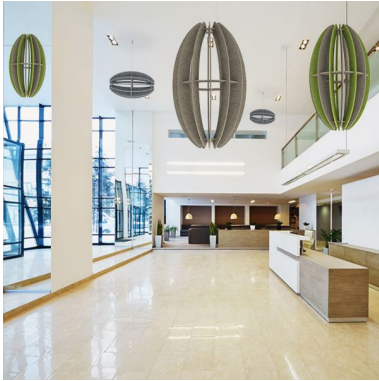

Texture:

Lustre:

Transparency:

DESCRIPTION / FEATURES	Baresque's Acoustic Clouds are available in a unique range of shapes and forms constructed from interlocking Zindra profiles. Easy to assemble and install, clouds will add drama to your space whilst simultaneously improving acoustics by utilising Zindra's powerful sound absorption properties.
HOW TO SPECIFY	1. Size 2. Zindra Colour
COMPOSITION	Flat pack Zindra cloud profiles, hanger heads, wire adjusters, S hooks, swaged wire
FINISHES AVAILABLE	Zindra Plain 1/2" (12mm) Color Range Zindra Timber 1/2" (12mm) Color Range
STANDARD SIZE	14.4" dia x 23.5" (364mm dia x 595mm) 27.3" dia x 47" (692mm dia x 1195mm)
WIDTH	MP60 - 150/152cm MP50 - 124/127cm MA50 - 124/127cm (adhesive backing)
ROLL LENGTH	30.5m Available by the lineal metre
WEIGHT	MP50 - 744 g/m ² MP60 - 967g/m ² MA50 (adhesive backing) - 893 g/m ²

INDOOR/OUTDOOR	Indoor only
WET AREAS	No
PATTERN REPEAT	N/A
SUGGESTED INSTALLATION	Cloud components supplied flat pack. Assembled cloud is then suspended from the ceiling using hanging hardware supplied. Download install guide for full assembly details.
CUSTOMISABLE	The Zintra Acoustic Solutions range is customisable to your project. Please get in touch with your local contact for details.
THERMOFORMABLE	No
FIRE RATING	ASTM E-84 – Class A E-13501 – B-s2-d0 AS 5637.1:2015 - Group 1
FABRICATION	Utility knife or CNC with an oscillating knife
REFINISHABLE	No
CARE INSTRUCTIONS	<p>Remove spills immediately using damp, clean cloth.</p> <p>Dab Zintra with a clean, soft white cloth dampened with a mild solution of liquid detergent and warm water. Repeat using only clean water, then pat dry with a lint free cloth.</p> <p>Avoid using wax polishes, solvents or concentrated abrasives.</p> <p>For more difficult stains, dampen a soft white cloth with a solution of household bleach (10% bleach / 90% water). Dab gently. Repeat using only a clean, water dampened cloth to remove bleach concentration then pat dry with a lint free cloth.</p> <p>Always test in an inconspicuous area first. If care instructions don't deliver the expected results, cease cleaning method immediately and</p>



	<p>contact Baresque for assistance.</p>
ENVIRONMENTAL INFORMATION	<p>We believe in the sustainability of both our planet and our people. We do everything we can to minimise our environmental impact and create spaces that contribute to the wellness of the people that use them.</p> <p>Certified by Declare and HPD, Zintra is made from 100% recyclable materials. It has low levels of volatile organic compounds and contains no formaldehyde. It's Red List Free and meets the Global Recycling Standard.</p> <p>Reducing noise levels, minimizing indoor air pollutants, easy cleaning and a Class A fire rating are just a few of the reasons that Zintra is the perfect material for the green buildings of today and tomorrow.</p>